



P Series Positive Displacement Vane Pumps

Numerous Applications

P Series vane pumps cover a large range of applications, from fluid to very viscous products, whether they are non-lubricating, abrasive or corrosive.

Wide Selection of Models

5 pump sizes (up to 110 m³/h and 12 bar max.) and 2 construction types (cast iron, and stainless steel) allow you to select a pump adapted exactly to your specific needs.

Constant High Performance Characteristics Throughout Time

Due to their excellent volumetric characteristics, the P Series vane pumps guarantee reduced energy consumption. Thanks to automatic adjustment, the performance characteristics remain constant throughout time.

The P Series pump can run in reverse.

Easy and Economical Maintenance

Wearing parts (vanes) can be replaced in situ without disconnecting the suction and discharge lines. Pump reassembly requires no special positioning. Replacement parts are extremely competitive.

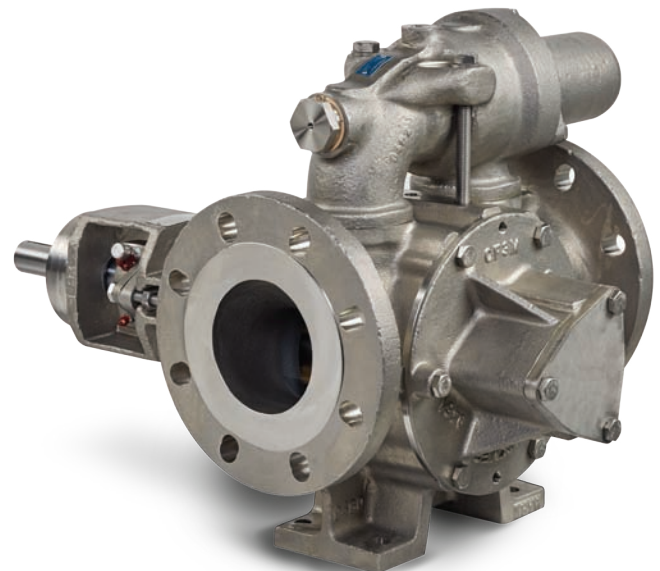
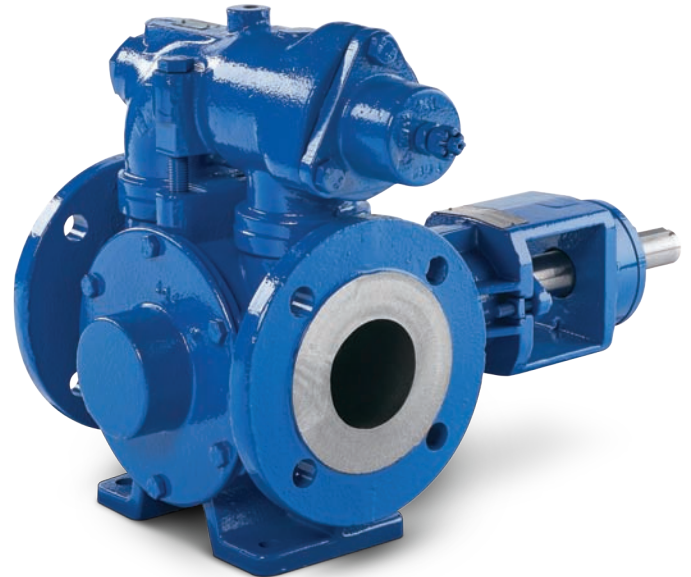

Flow rates up to 110 m³/h
12 bar pressure



P Series Positive Displacement Vane Pumps

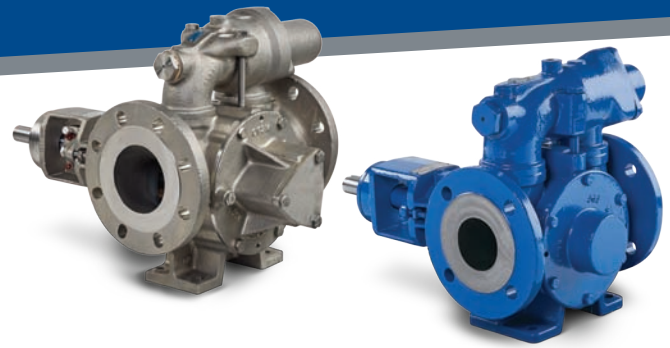

Characteristics

Pump Body

Depending on the type of product being pumped and the pump environment, two materials are available: cast iron or 316 L stainless steel.

Packing Materials

Depending on the required seal, the pump can be equipped with simple mechanical Mouvex seals, single/double standard mechanical seals or packed gland.

Vanes

According to the type of product to be pumped and operating conditions, the pump is equipped with polymer or metal vanes, either free or with push rods.

By-Pass

Depending on the process, the pump can be equipped with a cap plate, a single or double bypass.

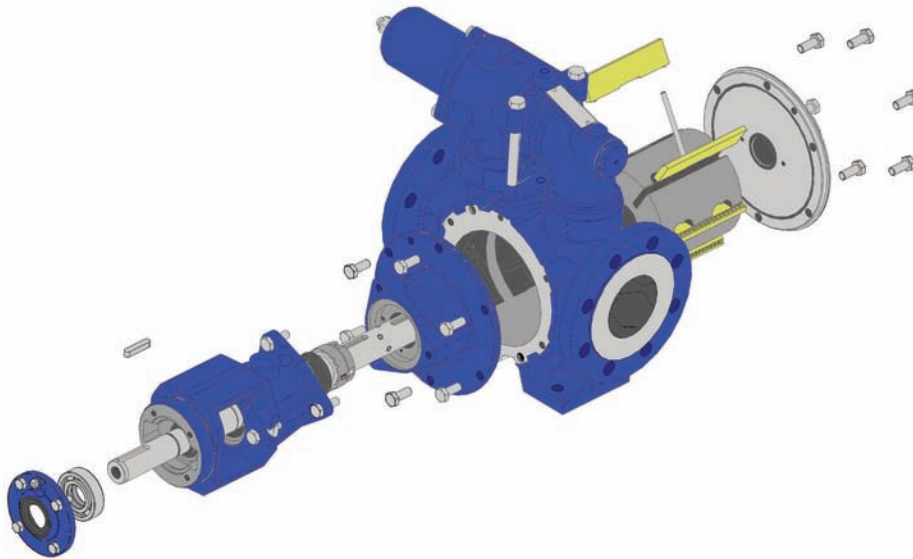

Operating Principle

Positive displacement, free vane pump. The rotation of the rotor and the vanes transfers of the liquid from the suction side to the discharge within the pump body (in a continuous movement).

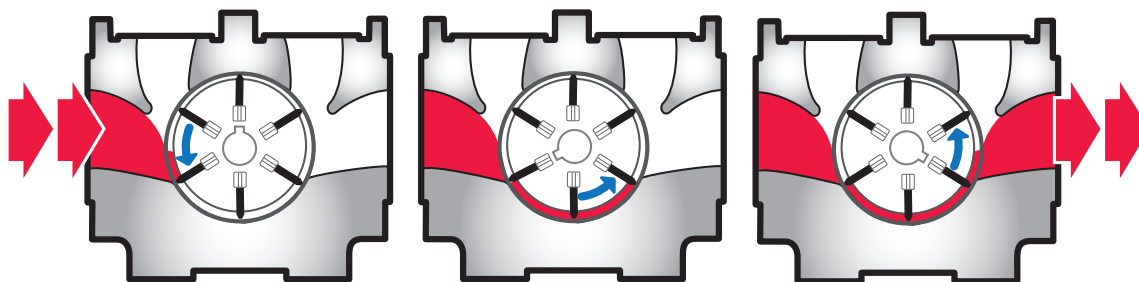



Applications

- **Energy:** Fuels, Gasoline, Diesel, Jet, Avgas, LFO, HFO, Biodiesel, Bioethanol, Lubricants, Mineral and Synthetic Oils, Greases
- **Chemical Industry:** Paint, Varnishes, Solvents, Resins, Methanol, Ethanol, Additives, various chemicals
- **Food Industry:** Cooking oils, Animal fats, Vegetable fats, Molasses, Alcohols

Performance Data

| | | P15 | P25 | P40 | P60 | P100 |
|---------------------------------|-------------------|-----|-----|-----|-----|------|
| Max. Flow Rate (at 1000 rpm) | m ³ /h | 15 | 25 | 40 | 65 | 110 |
| | gpm | 66 | 110 | 176 | 286 | 484 |
| Max. Differential Pressure | bar | 12 | | | | |
| | psi | 174 | | | | |
| Max. Temperature | °C | 250 | | | | |
| | °F | 482 | | | | |

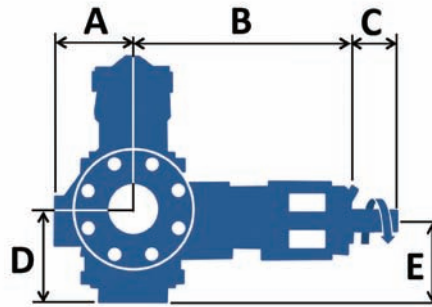
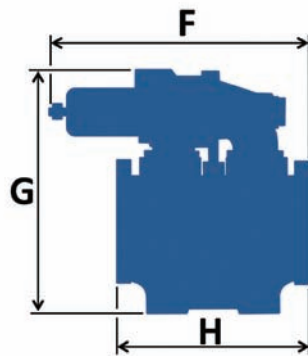

Dimensions

| | | P15 | P25 | P40 | P60 | P100 |
|--------|-----------|-------------|-------------|-------------|-------------|-------------|
| A | mm (in.) | 101 (3.98) | 101 (3.98) | 127 (5) | 141 (5.55) | 178 (7.01) |
| B | mm (in.) | 316 (12.44) | 316 (12.44) | 359 (14.14) | 371 (14.61) | 410 (16.14) |
| C | mm (in.) | 62.5 (2.46) | 62.5 (2.46) | 75 (2.95) | 74. (2.93) | 76 (2.99) |
| D | mm (in.) | 125 (4.93) | 125 (4.93) | 152 (5.98) | 185 (7.28) | 210 (8.27) |
| E | mm (in.) | 112 (4.41) | 112 (4.41) | 132 (5.2) | 160 (6.3) | 180 (7.09) |
| F | mm (in.) | 323 (12.72) | 323 (12.72) | 435 (17.13) | 455 (17.91) | 483 (19.02) |
| G | mm (in.) | 327 (12.87) | 327 (12.87) | 402 (15.83) | 412 (16.22) | 505 (19.88) |
| H | mm (in.) | 250 (9.84) | 250 (9.84) | 320 (12.6) | 360 (14.17) | 400 (15.75) |
| Weight | kg (lbs.) | 41 (90.4) | 41 (90.4) | 69 (153) | 75 (166) | 175 (386) |



ZI la Plaine des Isles • 2 rue des Caillottes
F-89000 AUXERRE - FRANCE
T: + 33.3.86.49.86.30
F: + 33.3.86.46.42.10
contact@mouvex.com
mouvex.com

Where Innovation Flows



Authorized PSG Partner: